

SKYLINE DESIGN INSTALLATION GUIDE FOR VITRACOLOR®, DEFINE GLASS- BOARDS™, DEFINE FRAME™

PAGES 2-4 *DIRECT-ADHERE TO WALL*

PAGES 5-7 *FORMED METAL BACKER + Z-CLIP*

PAGES 8-9 *EDGE-GRIPS*



SKYLINE DESIGN INSTALLATION GUIDE

VITRACOLOR®, DEFINE GLASSBOARDS™

DIRECT-ADHERE TO WALL



SKYLINE DESIGN INSTALLATION GUIDE

DEFINE GLASSBOARDS™, VITRACOLOR®

DIRECT-ADHERE TO WALL

READ BEFORE BEGINNING.

Determine if the glassboard size and weight requires two people for installation. Store and transport the glass panels in the original crate or an appropriate glass L-card with the bottom edge of the glassboard supported by wood or rubber pads. Do not allow any hard or abrasive materials to come in contact with the glassboard. The following are general guidelines only. The customer is responsible for ensuring that the installation method and materials are appropriate for the conditions on-site.

RECOMMENDED PRODUCTS

- Load-Supporting Mechanical Fasteners
- 3M 4991 VHB Tape
- DOW 995 Silicone Adhesive

- 1** Ensure wall and glass are clean and free of debris before installing. Glass panels should be applied over drywall sealed with a PVA primer. All edges and joints should also be sealed.
- 2** Skyline Design recommends the use of load-supporting mechanical fasteners at the top and bottom in addition to the adhesive. 3M 4991 VHB Tape can also be used to assist in holding the panel in position while the silicone adhesive cures.
- 3** When mechanical fasteners are used, ensure that they are securely anchored to the wall using fasteners/anchors appropriate for the wall type and load.
- 4** Apply DOW 995 Silicone Adhesive in 2" Diameter x ½" thick dots on the back side of the glass. Adhesive should be placed 4" from edge of panel. Maximum 8" between each adhesive dot. See diagram for measurements.
- 5** See Skyline Design Warranty & Maintenance Guidelines for further details on substrate preparation and application of adhesive. Use of adhesives other than DOW 995 Silicone Adhesive may damage the glass panel finish. Installation over materials other than drywall sealed with a PVA primer may harm the glass panel's finish. Contact Skyline Design for additional information on suitability of alternative substrates.

For questions, and to purchase markers & accessories: glassboards@skydesign.com

Skyline Design offers a limited lifetime warranty on glassboards against manufacturer defect or workmanship. See Terms and Conditions for full warranty. Final installation is not the responsibility of Skyline Design.

SKYLINE DESIGN INSTALLATION GUIDE

DEFINE GLASSBOARDS™, VITRACOLOR®

DIRECT-ADHERE TO WALL

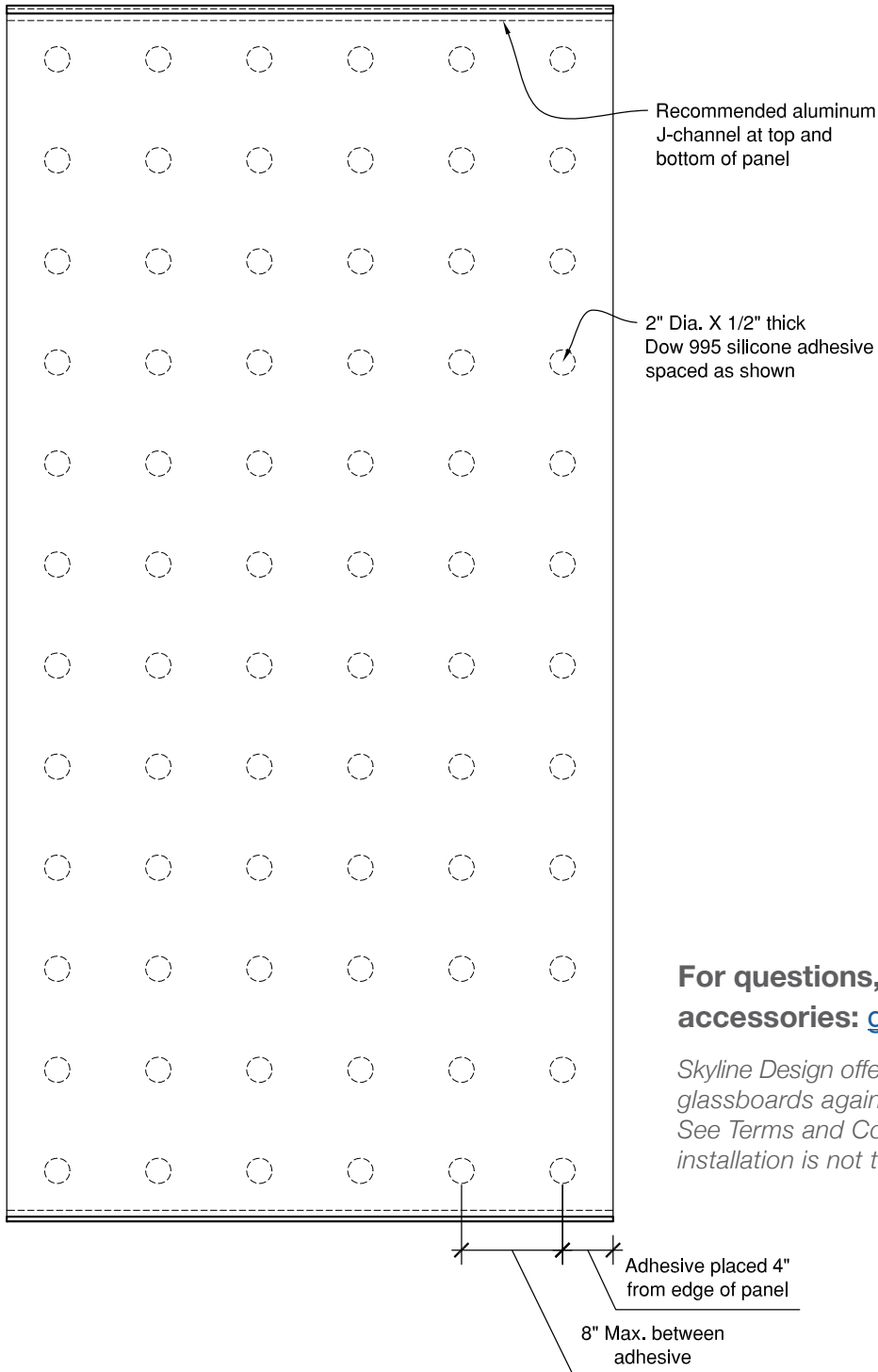

For questions, and to purchase markers & accessories: glassboards@skydesign.com

Skyline Design offers a limited lifetime warranty on glassboards against manufacturer defect or workmanship. See Terms and Conditions for full warranty. Final installation is not the responsibility of Skyline Design.

SKYLINE DESIGN INSTALLATION GUIDE

VITRACOLOR[®], DEFINE GLASSBOARDS[™], DEFINE FRAME

FORMED METAL BACKER + Z-CLIP



SKYLINE DESIGN INSTALLATION GUIDE

VITRACOLOR[®], DEFINE GLASSBOARDS[™], DEFINE FRAME

FORMED METAL BACKER + Z-CLIP

READ BEFORE BEGINNING.

Determine if the glassboard size and weight requires two people for installation. Store and transport the glass panels in the original crate or an appropriate glass L-card with the bottom edge of the glassboard supported by wood or rubber pads. Do not allow any hard or abrasive materials to come in contact with the glassboard.

Magnetic glassboards weigh approximately 5 pounds per square foot. Refer to your qualified installer and hardware specifications to ensure that the appropriate fasteners for your field condition are being used. EG: 8'x4' = approx. 160lbs, 6'x4' = approx. 120lbs.

PARTS INCLUDED

- Z-clip cleat
- Glassboard with metal backer
- Marker rail (add-on)

REQUIRED

- Drill
- Level
- Wall fasteners

Recommended: Size #8, 2" flat head multi material screw with twist-n-lock 75# medium duty drywall anchors

Attachment Detail

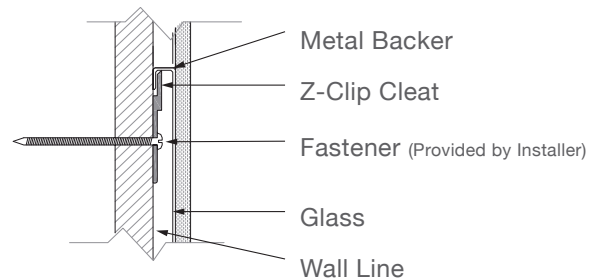

Attachment Detail: DEFINE[™] FRAME

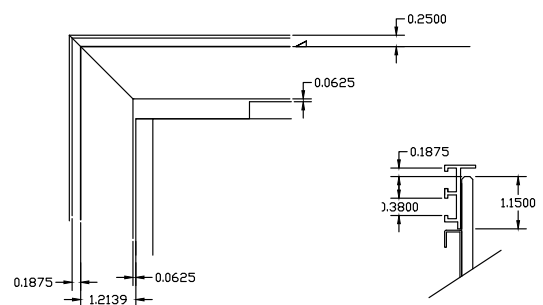

Frame = Glass + .50"

Finished 4-Way Backer = Glass - 2.5"

SKYLINE DESIGN INSTALLATION GUIDE

VITRACOLOR[®], DEFINE GLASSBOARDS[™], DEFINE FRAME

FORMED METAL BACKER + Z-CLIP

- 1** Draw guidelines on the wall using the metal backer as a guide for z-clip cleat(s) spacing.
- 2** Transfer fastener locations to the hanging z-clip cleat(s) and drill fastener holes in the z-clip cleat(s).
- 3** Level the z-clip cleat(s) and align it with the layout marks.
- 4** Attach z-clip cleat(s) to the wall with appropriate fasteners. Hanging brackets must be straight. Use shims if the wall surface is uneven.
- 5** Lift the glassboard and hang the rounded metal lip over the z-clip cleat(s).

If added protection is needed, double-sided foam tape can be applied to the return at the bottom of the metal backer to keep the glassboard from moving.

Check the distance from top of glass to top of lip on metal backer. Variances between panels will require adjustment to the wall-side z-clip cleat height to compensate for any differences. If necessary, use thin shims on top of cleats.

MARKER RAIL

The face mounted marker rail (optional) is attached using a heavy duty tape, which is already applied to the back.

Adhesive is permanent and cannot be repositioned. Improperly positioned rails must be cut off and repurchased.

- 1** Determine rail location and clean mounting area with the included alcohol wipe.
- 2** Wipe the glass surface where the tape will touch the glass, with the provided adhesion promoter.
- 3** Use a level to position the rail.
- 4** Peel protective strip tape on back of rail. Using the level as a guide, press the rail onto the glass, applying pressure along the full length of rail.

For questions, and to purchase markers & accessories: glassboards@skydesign.com

Skyline Design offers a limited lifetime warranty on glassboards against manufacturer defect or workmanship. See Terms and Conditions for full warranty. Final installation is not the responsibility of Skyline Design.

S | Skyline Design

Made in Chicago / © Skyline Design

888-278-4660 / skydesign.com

SKYLINE DESIGN INSTALLATION GUIDE

VITRACOLOR[®], DEFINE GLASSBOARDS[™]

EDGE-GRIPS



READ BEFORE BEGINNING.

These installation recommendations assume that the glassboard is installed on 5/8" thick drywall in new condition. It is the sole responsibility of the installer to verify that the wall structure and substrate are suitable for the installation method and that the product is installed properly and safely.

PARTS INCLUDED

- Glassboard
- Edge Grips
- Toggle Wall Anchors
- 1/4-20 x 2.5" Button Head Screws
- Set Screws
- 3/32" Allen Wrench
- 5/32" Allen Wrench

REQUIRED

- Drill
- Level
- Cork Pads
- 1/8" & 1/2" Diameter Drill Bits

SKYLINE DESIGN INSTALLATION GUIDE

VITRACOLOR[®], DEFINE GLASSBOARDS[™]

EDGE-GRIPS

1 Using a level, mark the location of glassboard on the wall.

2 Drill a 1/8" pilot hole at each hole location.

Installing to hollow wall?



Continue to Step 3.

Anchoring to studs or solid blocking?



Skip to Step 8.

3 Drill a 1/2" diameter hole at each pilot hole location.

4 Holding the anchor, insert the metal toggle into the hole.

5 Align the ends of the plastic straps and pull to seat the metal toggle against the drywall. Slide the plastic cap snug to the wall surface, ensuring that the notch on the side of the cap is horizontal.

6 Snap the plastic straps off

7 Attach an edge grip housing at each mounting location. For hollow wall installations use the included 1/4-20 x 1.5" button head screws and toggle anchors.



8 To attach to studs or solid blocking use an appropriately sized wood screw. Tighten edge grip housing securely in place. Ensure that the set screw hole faces up for the top mounting locations and down for the bottom locations.

9 Place a cork pad on each of the lower edge grip inserts.

10 Slide the lower edge grips into the lower housings. Install a set screw in each lower housing and tighten in place, leaving approximately 3/8" clearance.

11 Using 2 people, lift glassboard into place and set gently on the lower edge grips.

12 While holding the panel in place, place an edge grip insert over the glass at each top mounting location and slide into the edge grip housings. Secure each insert in place with a set screw.

13 Working on a single mounting location at a time: loosen the set screw, press in firmly on the edge grip insert, and tighten the set screw securely.

For questions, and to purchase markers & accessories: glassboards@skydesign.com

S | Skyline Design

Made in Chicago / © Skyline Design

Skyline Design offers a limited lifetime warranty on glassboards against manufacturer defect or workmanship. See Terms and Conditions for full warranty. Final installation is not the responsibility of Skyline Design.

888-278-4660 / skydesign.com